



Solartech Power, Inc.
SPECIFICATIONS

ELECTRICAL CHARACTERISTICS			
Model	SPM075M-F		
Power at STC (Pm)	75W		
Maximum power voltage (Vpm)	20.1V		
Maximum power current (Ipm)	3.87A		
Open circuit voltage (Voc)	24.5V		
Short circuit current (Isc)	4.17A		
Tolerance	±5%		
Module efficiency	18.0%		
Standard test conditions	Temperature 25°C, Irradiance 1000W/m ² , AM=1.5		
Maximum system voltage	1000V DC	Series fuse rating	15A
Temperature coefficient	Isc: 0.05%/°C	Voc: -0.36%/°C	Pmax: -0.46%/°C

Specifications	
Cell	Monocrystalline silicon solar cell, (156mmx65mm)
No. of cell and connection	36 (4x9)
Dimension	652 (25.7in) mm x 639 (25.2in) mm x 35 (1.38in) mm
Weight	6.0KG

AMBIENT CONDITIONS	
Operating Temperature	-40°C to +85°C
Storage Humidity	<90%

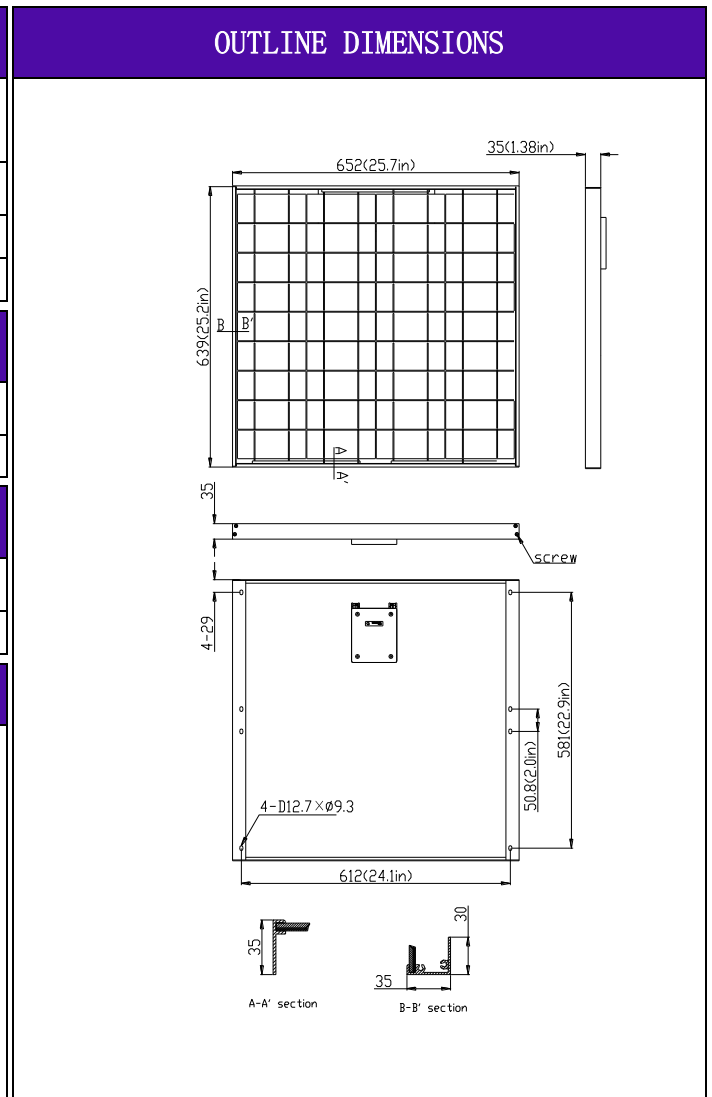
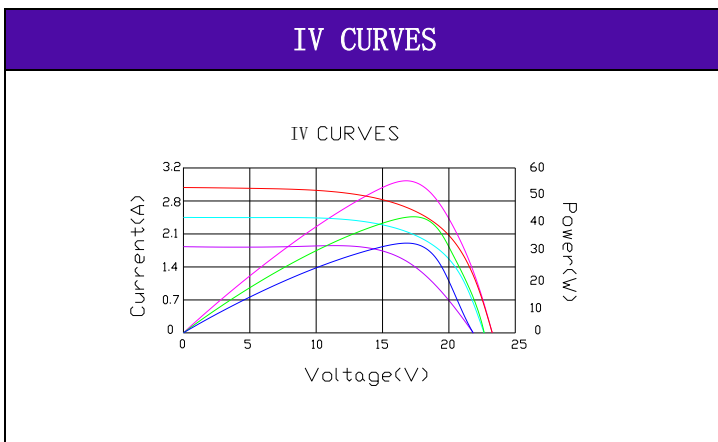
Output	
Type of output terminal	Junction box
Cable	



SOLARTECH POWER, INC.
 901 E CEDAR ST
 ONTARIO, CA 91761 USA
www.solartechpower.com
sales@solartechpower.com
 TOLL: 866-777-6527
 TEL: 909-673-0178
 FAX: 909-947-2919